

NOTES TO USERS

is for use in administering the National Flood Insurance Program. It is necessary to identify all areas subject to flooding, particularly from local sources of small size. The community map repository should be updated for possible updated or additional flood hazard information.

in more detailed information in areas where Base Flood Elevations and/or floodways have been determined, users are encouraged to consult Flood Profiles and Floodway Data and/or Summary of Stillwater Elevations obtained within the Flood Insurance Study (FIS) report that accompanies this map. Users should be aware that BFEs shown on the FIRM represent whole-foot elevations. These BFEs are intended for Flood Insurance purposes only and should not be used as the sole source of flood information. Accordingly, flood elevation data presented in the FIS should be utilized in conjunction with the FIRM for purposes of flood insurance and/or floodplain management.

Base Flood Elevations shown on this map apply only to landward areas of the floodway. Flood elevations are also provided in the Summary of Stillwater Elevations table in the Flood Insurance Study report. Floodway elevations shown in the Summary of Stillwater Elevations should be used for construction and/or floodplain management purposes if they are higher than the elevations shown on this FIRM.

of the floodways were computed at cross sections and interpolated at cross sections. The floodways were based on hydraulic considerations and to requirements of the National Flood Insurance Program. Floodway and other pertinent floodway data are provided in the Flood Insurance Study report for this jurisdiction.

areas not in Special Flood Hazard Areas may be protected by flood structures. Refer to Section 2.4 "Flood Protection Measures" of the Flood Insurance Study report for information on flood control structures and jurisdiction.

ection used in the preparation of this map was Universal Transverse Mercator (UTM) zone 14. The horizontal datum was NAD83, GRS1980. Differences in datum, spheroid, projection or UTM zone used in the production of FIRMs for adjacent jurisdictions may result in slight positional differences in map features across jurisdiction boundaries. These differences do not affect the accuracy of this FIRM.

levations on this map are referenced to the North American Vertical Datum of 1988. These flood elevations must be compared to structure and elevations referenced to the same vertical datum. For information on conversion between the National Geodetic Vertical Datum of 1929 and the North American Vertical Datum of 1988, visit the National Geodetic Survey website at <http://www.ngs.noaa.gov/> or contact the National Geodetic Survey at the following address:

Information Services
NADCON
Geospatial Survey
#202
1400 West Highway
Beltz, MD 20719-3282

current elevation, description, and/or location information for bench marks on this map, please contact the Information Services Branch of the National Geodetic Survey at (301) 713-3242, or visit its website at www.ngs.noaa.gov/.

Information shown on this FIRM was derived from information provided by the Census Bureau, City of Lawton Engineering Division and Comanche County Flooded at a scale of 1:24000, dated 2001 or later.

reflects more detailed and up-to-date stream channel configurations as shown on the previous FIRM for this jurisdiction. The floodplains shown on this map were transferred from the previous FIRM and have been modified to conform to these new stream channel configurations. As a result, the Flood Profiles and Floodway Data tables in the Flood Insurance Study report (which contains authoritative hydraulic data) may reflect stream channel configurations that differ from what is shown on this map.

limits shown on this map are based on the best data available at the time of publication. Because changes due to annexations or de-annexations may occur after this map was published, map users should contact the community officials to verify current corporate limit locations.

refer to the separately printed Map Index for an overview map of the City of Lawton showing the layout of map panels, community map repository addresses, and listing of Communities table containing National Flood Insurance Program information for each community as well as a listing of the panels on which each community is located.

the FEMA Map Service Center at 1-800-358-9616 for information on products associated with this FIRM. Available products may include issued Letters of Map Change, a Flood Insurance Study report, digital versions of this map. The FEMA Map Service Center may also be contacted by Fax at 1-800-358-9620 and its website at <http://www.msc.fema.gov/>.

ive questions about this map or questions concerning the National Flood Insurance Program in general, please call 1-877-FEMA-MAP (1-877-336-2627) or visit the FEMA website at <http://www.fema.gov/>.

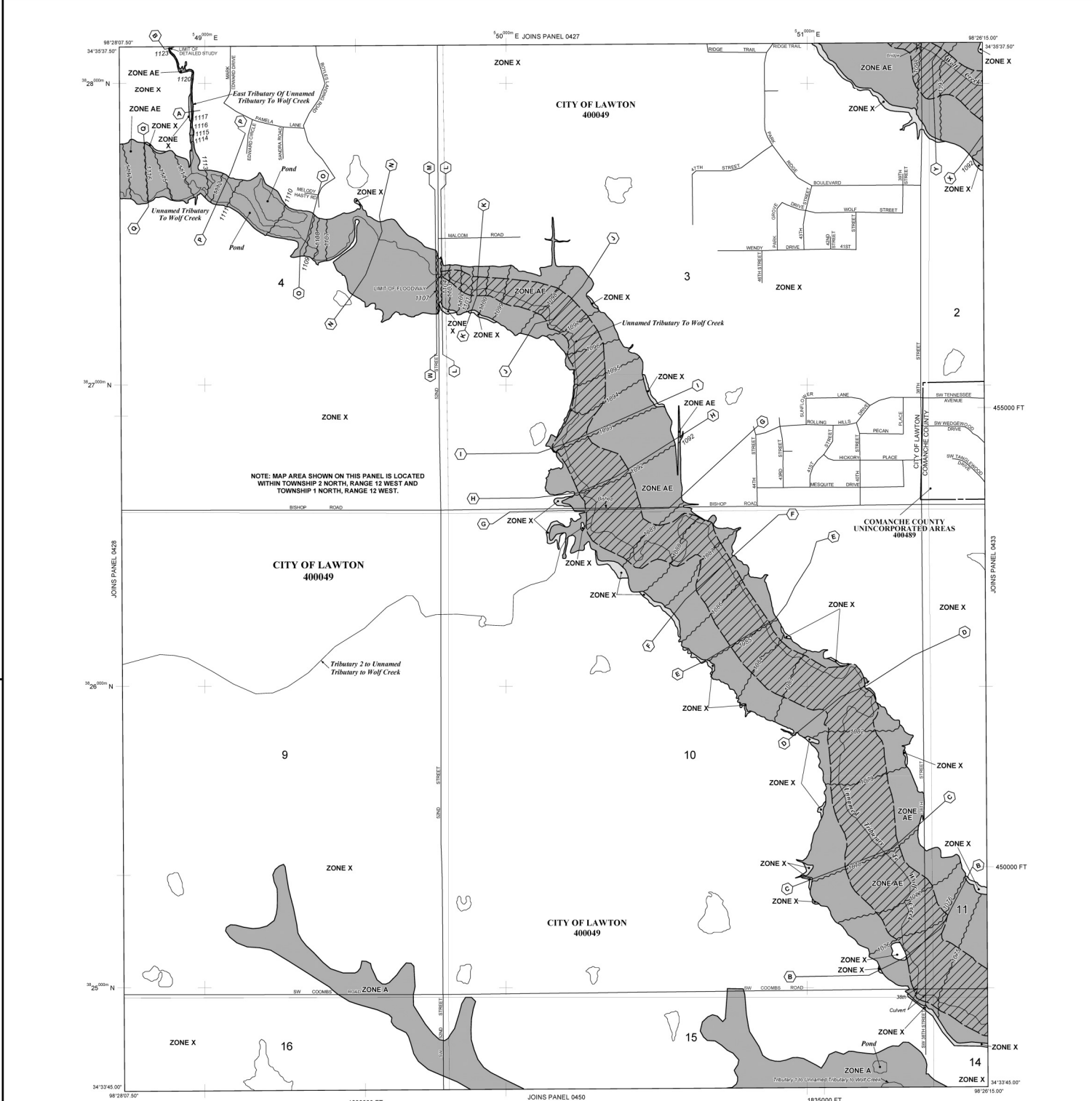

LEGEND

SPECIAL FLOOD HAZARD AREAS (SFHAs) SUBJECT TO INUNDATION BY THE 1% ANNUAL CHANCE FLOOD

The 1% annual chance flood (100-year flood), also known as the base flood, is that flood that has a 1% chance of being equaled or exceeded in any given year. The Flood Hazard Area is the area subject to flooding by the 1% annual chance flood. Special Flood Hazard Areas include Zone AE, Zone X, Zone A, Zone V, and Zone VE. Flood Elevation is the water surface elevation of the 1% annual chance flood.

ZONE A No Base Flood Elevations determined.
ZONE AE Base Flood Elevations determined.
ZONE X Flood depths of 1 to 3 feet (usually areas of ponding); Base Flood Elevations determined.
ZONE AD Flood depths of 1 to 3 feet (usually sheet flow on sloping terrain); energy depths determined. For areas of abutment flooding, also determined.
ZONE AR Special Flood Hazard Area formerly protected from the 1% annual chance flood by a flood control system that was subsequently abandoned. Zone AR indicates that the former flood control system is being protected to provide protection from the 1% annual chance greater flood.
ZONE AV Area to be protected from 1% annual chance flood by a flood protection system under construction; no Base Flood Elevation determined.
ZONE V Coastal flood zone with velocity hazard (wave action); no Base Flood Elevations determined.
ZONE VE Coastal flood area with velocity hazard (wave action); Base Flood Elevations determined.

FLOODWAY AREAS IN ZONE AE

The floodway is the channel of a stream plus any adjacent floodplain areas that keep free of encroachment so that the 1% annual chance flood can be carried without substantial increases in flood heights.

OTHER FLOOD AREAS

ZONE X Areas of 0.2% annual chance flood; areas of 1% annual chance flood with average depths of less than 1 foot or with drainage areas less than 1 square mile; and areas protected by levees from 1% annual flood.
ZONE A Areas determined to be outside the 0.2% annual chance floodplain.
ZONE D Areas in which flood hazards are undetermined, but are potential.

COASTAL BARRIER RESOURCES SYSTEM (CBRS) AREAS

OTHERWISE PROTECTED AREAS (OPAs)

CBRS areas and OPAs are normally located within or adjacent to Special Flood Hazard Areas.

BOUNDARIES

Floodplain boundary
 Floodway boundary
 Zone D boundary
 CBRS and OPA boundary

BOUNDARY DIVIDING SPECIAL FLOOD HAZARD AREAS OF BASE FLOOD ELEVATION, FLOOD DEPTHS OR FLOOD VELOCITY

Base Flood Elevation line and value, elevation in feet* (EL 967)
 Base Flood Elevation value where uniform within elevation in feet*

* Referenced to the North American Vertical Datum of 1988 (NAVD 88)

CROSS SECTION LINE

Transect line
 Geographic coordinates referenced to the North American Vertical Datum of 1988 (NAVD 88)
 1000-foot Universal Transverse Mercator grid ticks, and 500-foot grid ticks; Oklahoma State Plane or UTM system, south zone (FIPS ZONE 3502) Lambert Conformal Conic Projection
 6000000.00 FT

BENCH MARK (SEE EXPLANATION IN NOTES TO USERS ON THIS FIRM PANEL)

DX5510
 M1.5
 River Mile

MAP REPOSITORIES

Refer to Map Repositories list on Map Index

EFFECTIVE DATE OF COUNTYWIDE FLOOD INSURANCE RATE MAP
 July 20, 2009
 EFFECTIVE DATE(S) OF REVISION(S) TO THIS PANEL

For community map revision history prior to countywide mapping, refer to the County Map History table located in the Flood Insurance Study report for this jurisdiction.

To determine if flood insurance is available in this community, contact your insurance agent or call the National Flood Insurance Program at 1-800-638-9620.

NATIONAL FLOOD INSURANCE PROGRAM

MAP SCALE 1" = 500'

250 0 250 500 1000 FEET
 150 0 150 300 METER

PANEL 0429E

FIRM FLOOD INSURANCE RATE COMANCHE COUNTY OKLAHOMA AND INCORPORATED AREAS

PANEL 429 OF 625
 (SEE MAP INDEX FOR FIRM PANEL LIST)

CONTAINS:

COMMUNITY	NUMBER	PANEL
COMANCHE COUNTY	0429	0429
LAWTON, CITY OF	40049	0429

Notice to User: The Map Number shown below is used when placing map orders. The Community Number above should be used on insurance applications for flood insurance.

MAP NUMBER 40031E
EFFECTIVE DATE JULY 20, 2009

Federal Emergency Management Agency