

Most Common Types of Crashes by Work Zone Area

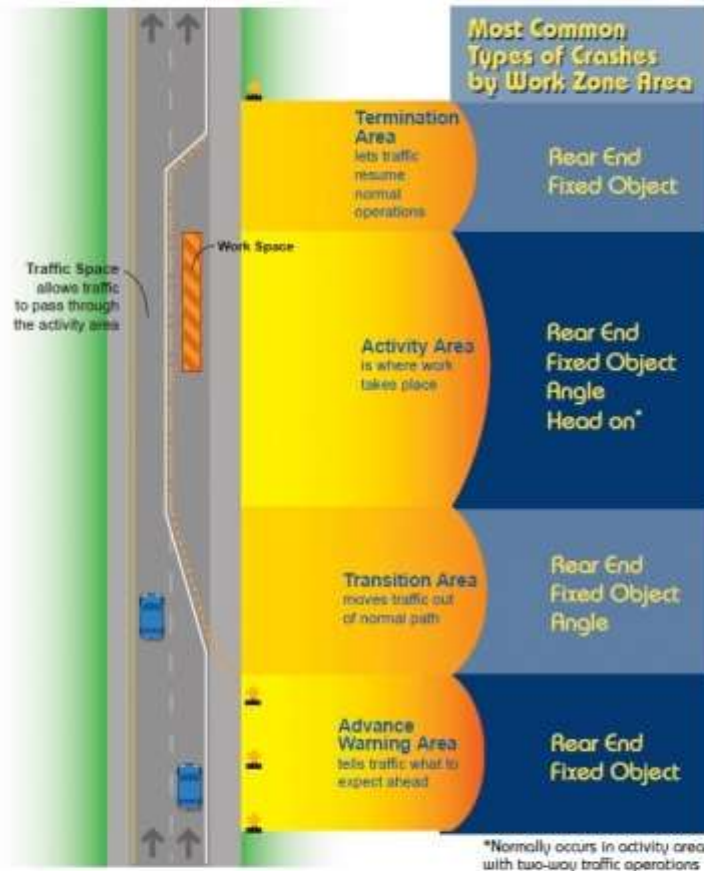

Legend

- Work Zone
- Direction of Travel
- Traffic Signs
- Channelizing Devices (Cones, Drums, Barricades)



<http://safety.fhwa.dot.gov/programs/wisz.htm>

U.S. Department
of Transportation
**Federal Highway
Administration**

Problem:

A driver in clear weather during mid-afternoon comes upon slow or stopped traffic due to a work zone and crashes into another vehicle, or in the process of avoiding such, crashes into a barrier, equipment or pedestrian.

Solution:

Follow the "Safety Tips"

Drive Smart:

**Buckle Up,
Slow Down,
Save a Life**

Work Zone Safety for Drivers



This brochure provides information to drivers on work zone safety.

FHWA-SA-03-012